



Gral.C.M.de Alvear 171  
(B1832BVC) - Lomas de Zamora



(+54 11) 3988-7001



Whatsapp  
(+54 911) 5383-9778



ventas@varitel.com



### Dimensions (Unit:mm)

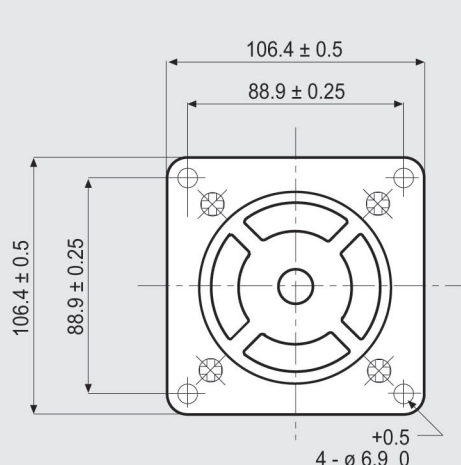

WIRES ARE HOUSED IN A VINYL TUBE.  
T IS THE EARTH TERMINAL.

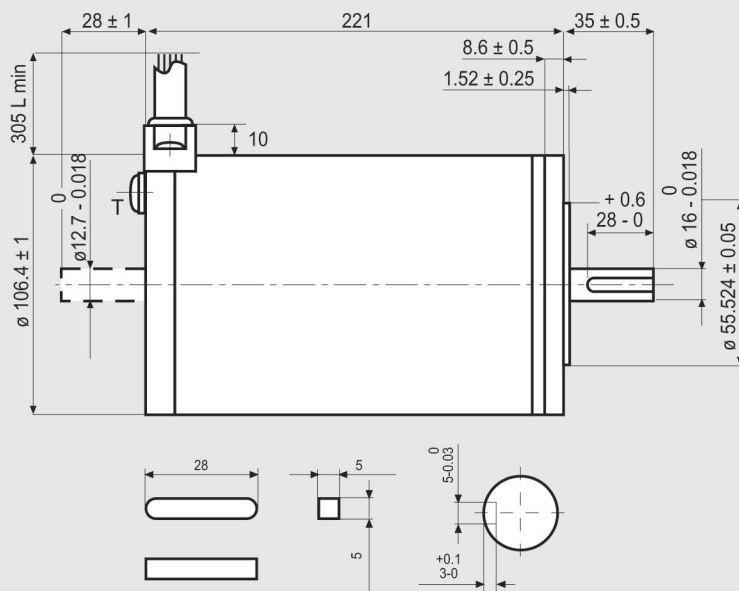

## FEATURES

MODEL		103-H89223-6341 (103-H89223-6311)
BASIC STEP ANGLE		1.8° ± 0.09°
BIPOLAR CURRENT	(Amp)	6.0
UNIPOLAR CURRENT	(Amp)	
RESISTANCE	(Ohm)	0.63
INDUCTANCE	(mH)	8.0
BIPOLAR HOLDING TORQUE	(Ncm)	2460
UNIPOLAR HOLDING TORQUE	(Ncm)	
ROTOR INERTIA	(Kgm <sup>2</sup> x 10 <sup>-7</sup> )	22000
THEORETICAL ACCELERATION	(rad x sec. <sup>-2</sup> )	11100
BACK E.M.F.	(V/Krpm)	410
MASS	(Kg)	10
PROTECTION DEGREE		IP43
LEADS CODE		V

Codes between brackets refer to double shaft models.

## TORQUE/SPEED CURVE

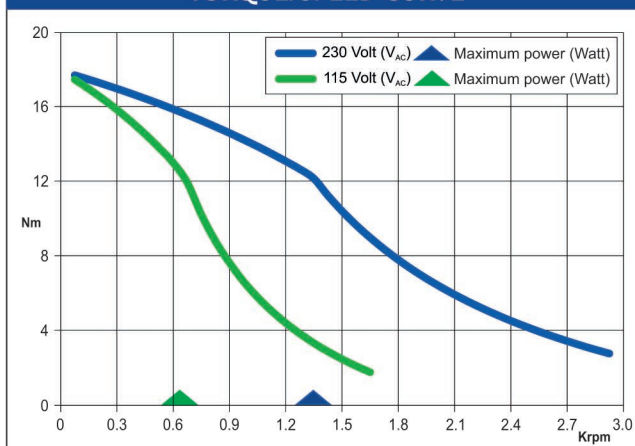

R.T.A. s.r.l. PAVIA (ITALY) SANYO DENKI CO., Ltd (JAPAN)

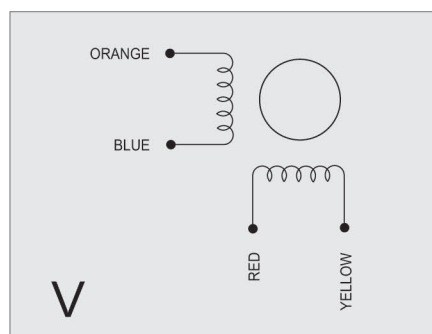

**Suggested R.T.A. drive model: X-MIND B6**



Gral.C.M.de Alvear 171  
(B1832BVC) - Lomas de Zamora



(+54 11) 3988-7001



**Whatsapp**  
**(+54 911) 5383-9778**



[ventas@varitel.com](mailto:ventas@varitel.com)



### Dimensions (Unit:mm)

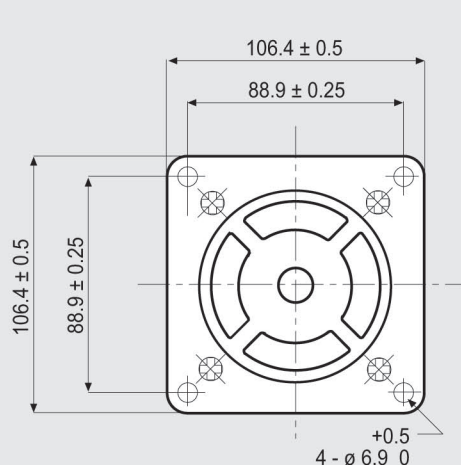

WIRES ARE HOUSED IN A VINYL TUBE.  
T IS THE EARTH TERMINAL.

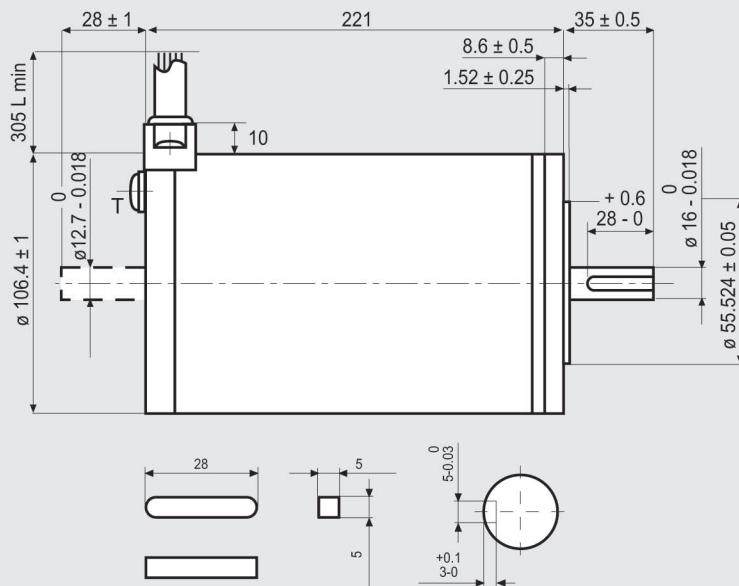

### FEATURES

MODEL	103-H89223-6341 (103-H89223-6311)
BASIC STEP ANGLE	1.8° ± 0.09°
BIPOLAR CURRENT (Amp)	6.0
UNIPOLAR CURRENT (Amp)	
RESISTANCE (Ohm)	0.63
INDUCTANCE (mH)	8.0
BIPOLAR HOLDING TORQUE (Ncm)	2460
UNIPOLAR HOLDING TORQUE (Ncm)	
ROTOR INERTIA (Kg m <sup>2</sup> x 10 <sup>-7</sup> )	22000
THEORETICAL ACCELERATION (rad x sec. <sup>-2</sup> )	11100
BACK E.M.F. (V/Krpm)	410
MASS (Kg)	10
PROTECTION DEGREE	IP43
LEADS CODE	V

Codes between brackets refer to double shaft models.

### TORQUE/SPEED CURVE

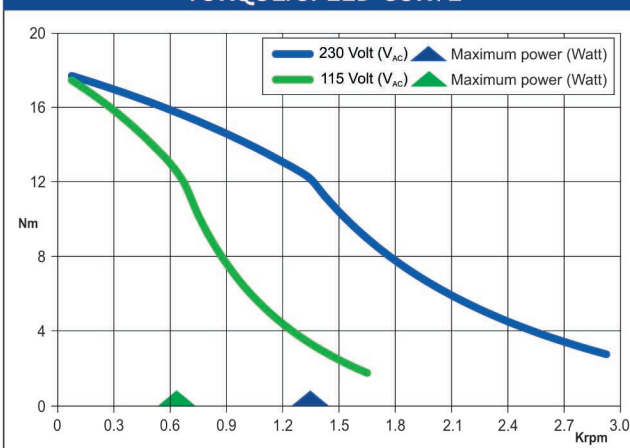

R.T.A. s.r.l. PAVIA (ITALY) SANYO DENKI CO., Ltd (JAPAN)

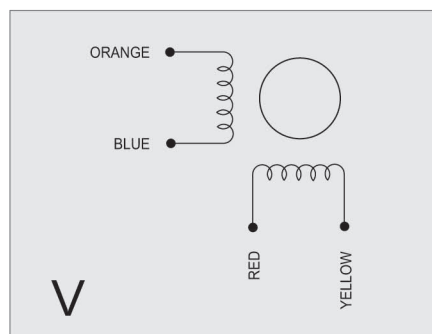

Suggested R.T.A. drive model: X-MIND B6



Gral.C.M.de Alvear 171  
(B1832BVC) - Lomas de Zamora



(+54 11) 3988-7001



Whatsapp  
(+54 911) 5383-9778



ventas@varitel.com



### Dimensions (Unit:mm)

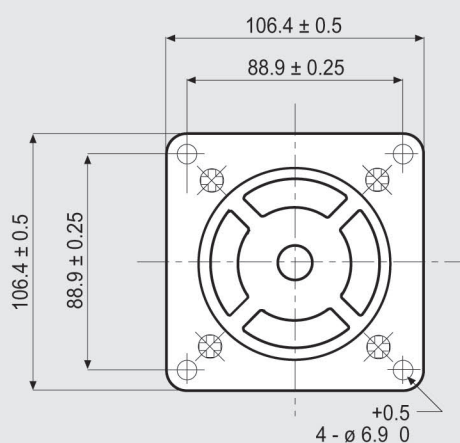

WIRES ARE HOUSED IN A VINYL TUBE.  
T IS THE EARTH TERMINAL.

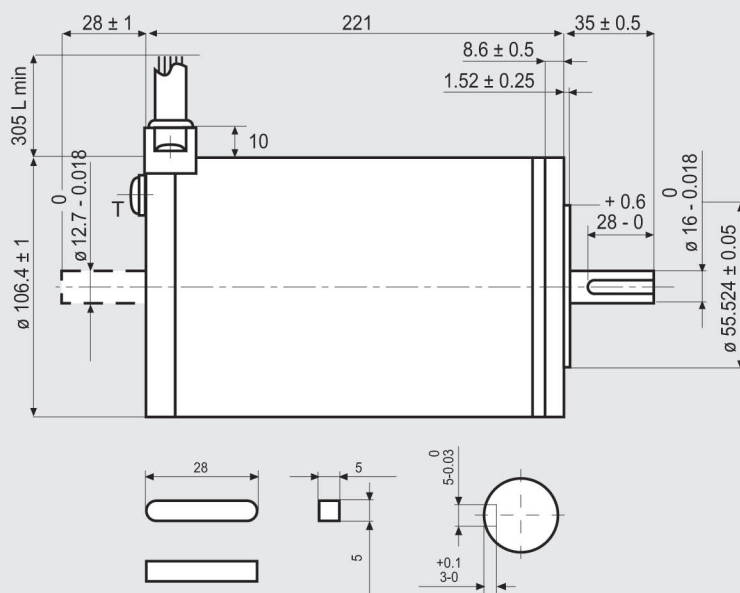

## FEATURES

MODEL		103-H89223-6641 (103-H89223-6611)
BASIC STEP ANGLE		1.8° ± 0.09°
BIPOLAR CURRENT	(Amp)	12.0
UNIPOLAR CURRENT	(Amp)	
RESISTANCE	(Ohm)	0.16
INDUCTANCE	(mH)	2.0
BIPOLAR HOLDING TORQUE	(Ncm)	2460
UNIPOLAR HOLDING TORQUE	(Ncm)	
ROTOR INERTIA	(Kgm <sup>2</sup> x 10 <sup>-7</sup> )	22000
THEORETICAL ACCELERATION	(rad x sec. <sup>-2</sup> )	11100
BACK E.M.F.	(V/Krpm)	205
MASS	(Kg)	10
PROTECTION DEGREE		IP43
LEADS CODE		V

Codes between brackets refer to double shaft models.

## TORQUE/SPEED CURVE

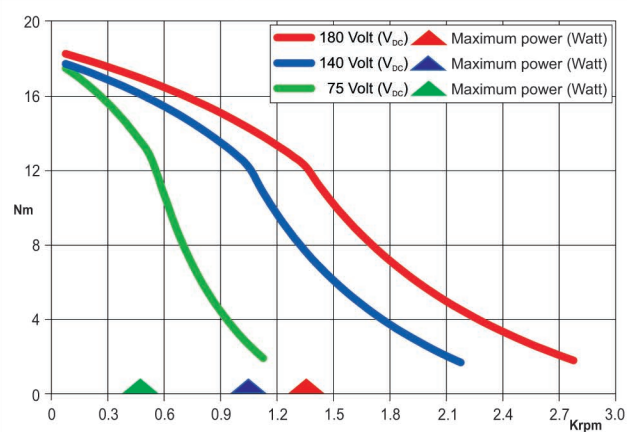

R.T.A. s.r.l. PAVIA (ITALY) SANYO DENKI CO., Ltd (JAPAN)

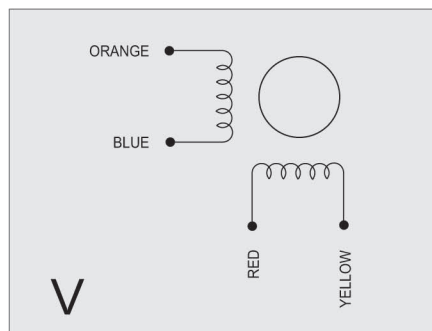

**Suggested R.T.A. series: PLUS**



Gral.C.M.de Alvear 171  
(B1832BVC) - Lomas de Zamora



(+54 11) 3988-7001



**Whatsapp**  
**(+54 911) 5383-9778**



*ventas@varitel.com*