

Dimensions (Unit:mm)

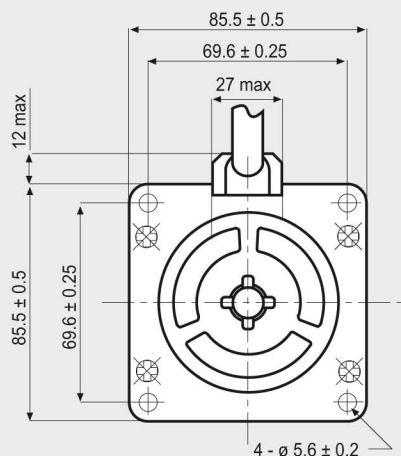

T IS THE EARTH TERMINAL

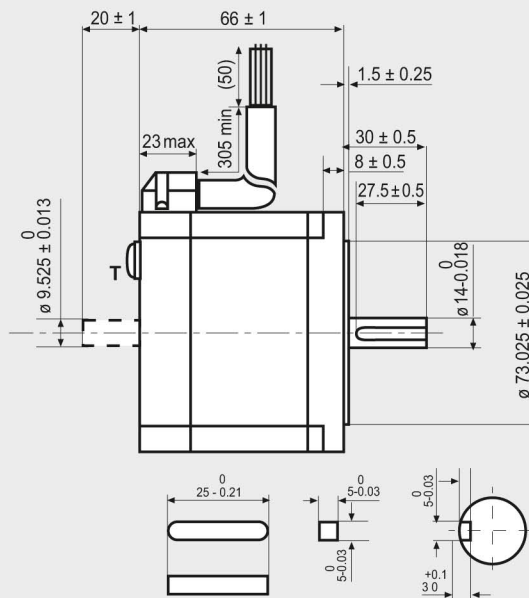

FEATURES

MODEL	SM 2861-5255 (SM 2861-5225)
BASIC STEP ANGLE	1.8° ± 0.09°
BIPOLAR CURRENT (Amp)	6.0
RESISTANCE (Ohm)	0.29
INDUCTANCE (mH)	1.7
BIPOLAR HOLDING TORQUE (Ncm)	360
ROTOR INERTIA (Kg m ² x 10 ⁻⁷)	1480
THEORETICAL ACCELERATION (rad x sec. ⁻²)	24300
BACK E.M.F. (V/Krpm)	60
MASS (Kg)	1.7
INTERNATIONAL STANDARDS	UL, CSA
INSULATION VOLTAGE (V)	250 V _{AC} (350 V _{DC})
PROTECTION DEGREE	IP43-F
LEADS CODE	V

Codes between brackets refer to double shaft models.

TORQUE/SPEED CURVE

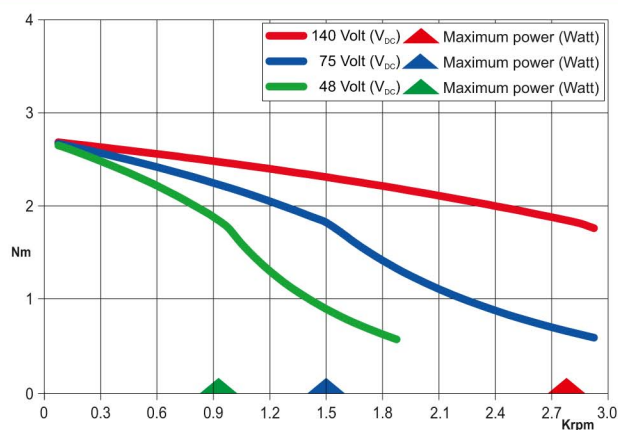

R.T.A. s.r.l. PAVIA (ITALY) SANYO DENKI CO., Ltd (JAPAN)

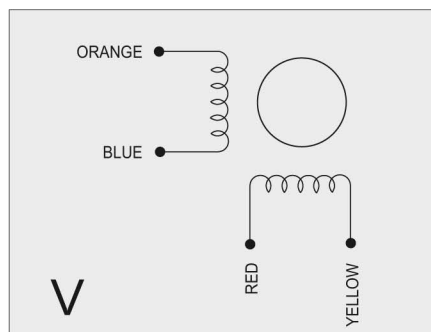

CU

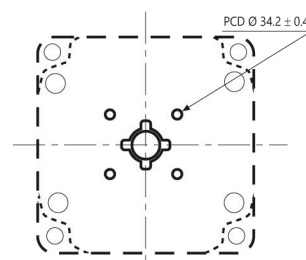

DOUBLE SHAFT MOTORS ONLY.
4 X M4 THREADED HOLES. TAP DEPTH 4.5 mm.

Suggested R.T.A. drive series: NDC, ADW, HGD, PLUS



Gral. C.M.de Alvear 171
(B1832BVC) - Lomas de Zamora



(+54 11) 3988-7001



Whatsapp
(+54 911) 5383-9778



ventas@varitel.com



[illegible]

Graph showing Torque (Nm) versus Speed (Krpm) for two motor configurations:

- 230 Volt (V_{AC}) - Maximum power (Watt)
- 115 Volt (V_{AC}) - Maximum power (Watt)

The graph illustrates the torque-speed characteristics for both configurations. The 230V configuration (blue line) maintains a higher torque across the speed range compared to the 115V configuration (green line). Both configurations show a sharp drop in torque after their respective maximum points.

R.T.A. s.r.l. PAVIA (ITALY) SANYO DENKI CO., Ltd (JAPAN)

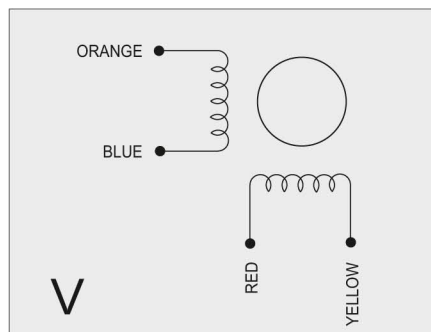

CRUS



www.varitel.com